

ORDINANCE NO. 6589

AN ORDINANCE appropriating \$618,354 to several Parks Capital Improvement Projects from unappropriated fund balance of Fund 337, Park Acquisition and Development; amending Ordinance No. 6213, Section 76, Attachment No. 1, as amended, and adding a new section.

BE IT ORDAINED BY THE COUNCIL OF KING COUNTY:

SECTION 1. There is hereby approved and adopted an appropriation of \$60,929 to C.I.P. Project No. 090103, Bellevue Pool; \$98,216 to C.I.P. Project No. 026003, Administration Costs; \$973 to C.I.P. Project No. 007258, Art in Parks; \$100,000 to C.I.P. Project No. 007041, Enumclaw Golf Course; \$61,868 to C.I.P. Project No. 090101, Federal Way Pool; \$66,500 to C.I.P. Project No. 007011, Fort Dent; \$97,300 to C.I.P. Project NO. 060011, Luther Burbank; and \$132,568 to C.I.P. Project No. 007122, West Sammamish River Trail; from unappropriated fund balance of Fund 337, Park Acquisition and Development.

SECTION 2. Ordinance No. 6213, Section 76, as amended, is hereby amended to read as follows:

PARK ACQUISITION AND DEVELOPMENT (~~(\$1,308,691)~~) \$1,927,045

SECTION 3. The project information sheets attached hereto are adopted to amend and revise the 1983 Capital Improvement Budget and Program, amending Ordinance No. 6213, Section 76, Attachment No. 1, as amended.

No. 3
 Eastside

ty,
 s.
 in
 or

Site Change



CAPITAL IMPROVEMENT PROGRAM

DEPARTMENT PRIORITY REQUEST	000	NEW 10/83
LOCATION -	601 - 143RD NE, BELLEVUE	
CURRENT PROJECT COST ESTIMATE		60,929
EXPENDED & APPROPRIATED (INC RECOMMENDED)		<u>60,929</u>
FUTURE FUNDING REQUIRED TO COMPLETE PROJECT		0
BUDGET *PROGRAM PROJECTIONS - THOUSANDS OF DOLLARS*		OPT/ACCOUNT
RECOMMENDED *PROGRAM*		TOTAL
(B+C) * 1984 1985 1986 1987 1988 TOTAL *		

		*
390 *		* 55,390
539 *		* <u>5,539</u>
929 *		* 60,929

929 *		* <u>60,929</u>
929 *		* 60,929
*		*

Project No. 6
Central

Community

Site Change

1984.

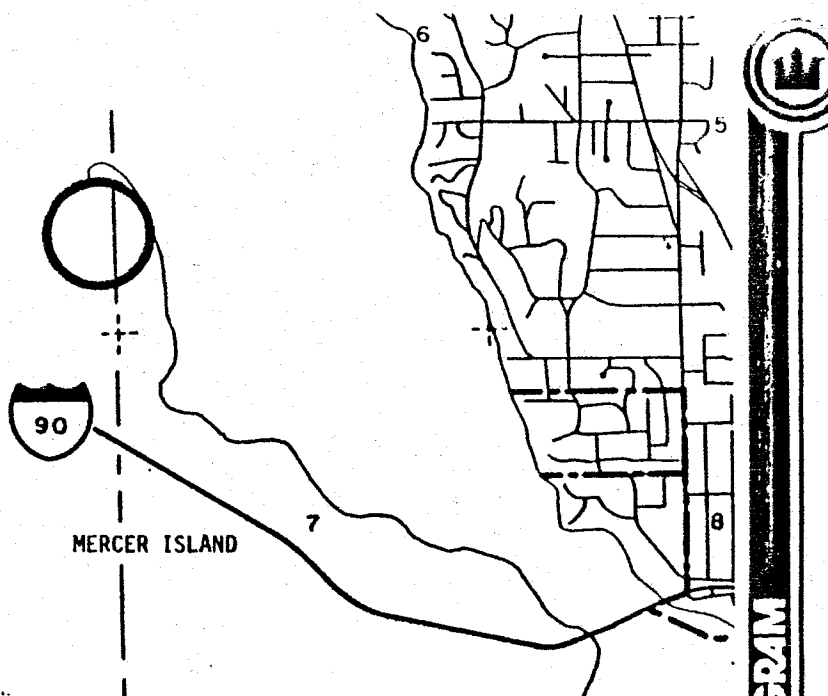

DEPARTMENT PRIORITY REQUEST 000		REVISED 10/83				
LOCATION - NORTH TIP OF MERCER ISLAND						
CURRENT PROJECT COST ESTIMATE		2,889,590				
EXPENDED & APPROPRIATED (INC RECOMMENDED)		2,889,590				
FUTURE FUNDING REQUIRED TO COMPLETE PROJECT		0				
BUDGET	*PROGRAM PROJECTIONS - THOUSANDS OF DOLLARS*				OPT/ACCOUNT	
ENDED	PROGRAM				TOTAL	
(+C)	* 1984	1985	1986	1987	1988	TOTAL
511	*					511
451	*					216,451
608	*					4,608
35	*					35
985	*					2,667,985
590	*					2,889,590
300	*					97,300
880	*					13,880
410	*					2,778,410
590	*					2,889,590

CAPITAL IMPROVEMENT PROGRAM

No. 6
 Central
 ended
 Site Change
 Assessment

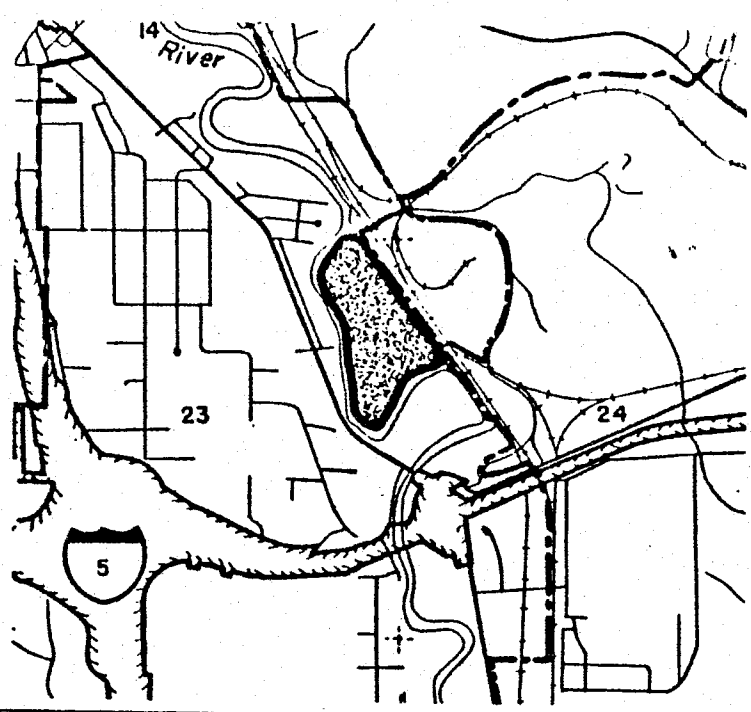

CAPITAL IMPROVEMENT PROGRAM

DEPARTMENT PRIORITY REQUEST 000 REVISED 10/83

LOCATION -
 CURRENT PROJECT COST ESTIMATE 3,779,162
 EXPENDED & APPROPRIATED (INC RECOMMENDED) 3,779,162

FUTURE FUNDING REQUIRED TO COMPLETE PROJECT 0

BUDGET	*PROGRAM PROJECTIONS - THOUSANDS OF DOLLARS*					OPT/ACCOUNT
EXPENDED	PROGRAM*					TOTAL
(+C)	* 1984	1985	1986	1987	1988	TOTAL *
354	*					4,354
62	*					62
212	*					266,212
661	*					66,661
350	*					4,350
523	*					3,437,523
162	*					3,779,162
500	*					66,500
662	*					3,712,662
162	*					3,779,162

No. 7
 Federal Way

ility
 e also

struction
 n
 occur in

Site Change

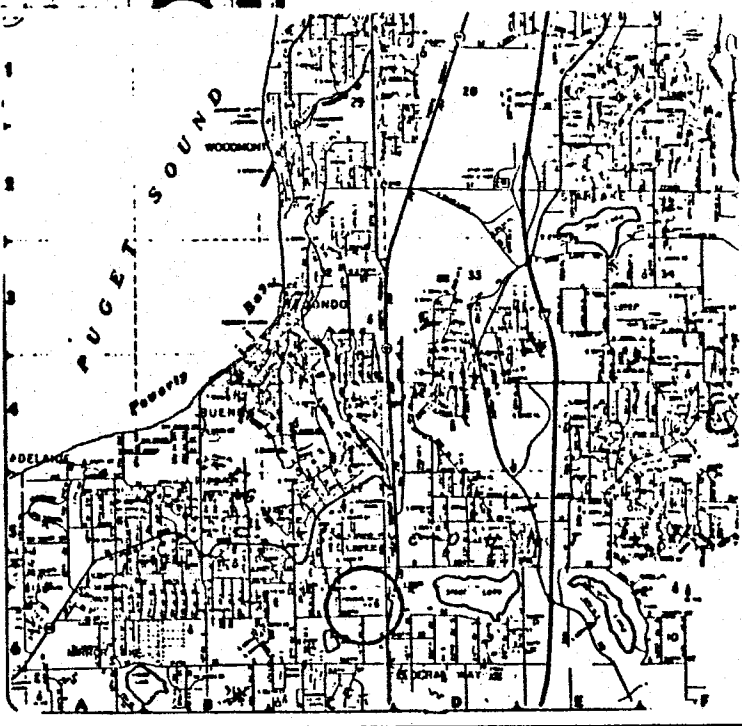

CAPITAL IMPROVEMENT PROGRAM

DEPARTMENT PRIORITY REQUEST 000 REVISED 10/83

LOCATION - FEDERAL WAY HIGH SCHOOL

CURRENT PROJECT COST ESTIMATE 61,868

EXPENDED & APPROPRIATED (INC RECOMMENDED) 61,868

FUTURE FUNDING REQUIRED TO COMPLETE PROJECT 0

BUDGET RECOMMENDED (B+C)	PROGRAM PROJECTIONS - THOUSANDS OF DOLLARS*					OPT/ACCOUNT TOTAL
	1984	1985	1986	1987	1988	PROGRAM* TOTAL
,000						50,000
,000						5,000
,868						6,868
,868						61,868
,868						61,868
,868						61,868

District: No. 9
 Planning Area: Enumclaw

law. The
 cluded the
 n of a parking
 Acquisition

83 to replace

Cost Change Site Change
 Rule Change

ark scheduled for 1983.

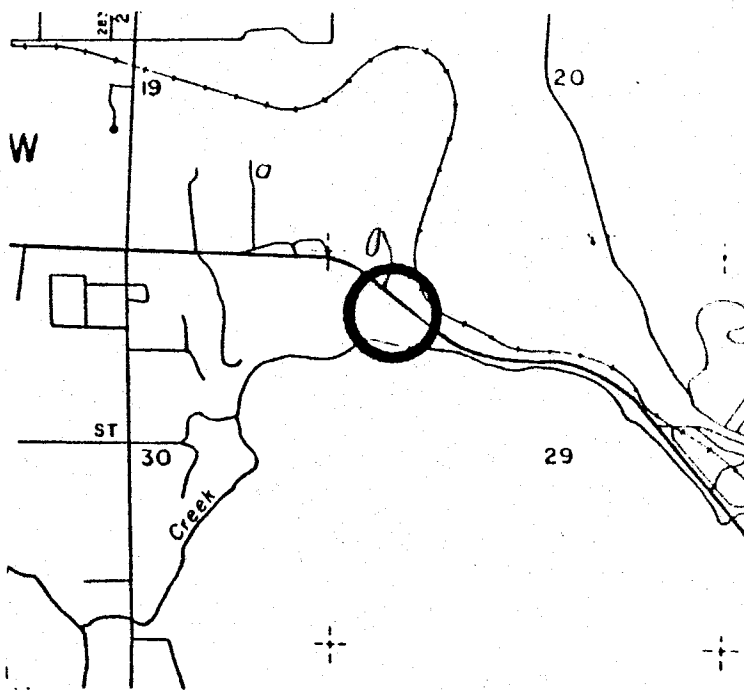

DEPARTMENT PRIORITY REQUEST 000 REVISED 10/83

LOCATION - FAIRGROUNDS AT ENUMCLAW

CURRENT PROJECT COST ESTIMATE 597,321

EXPENDED & APPROPRIATED (INC RECOMMENDED) 597,321

FUTURE FUNDING REQUIRED TO COMPLETE PROJECT 0

EXP + BUDGET RECOMMENDED (A+B+C)	*PROGRAM PROJECTIONS - THOUSANDS OF DOLLARS*					* OPT/ACCOUNT PROGRAM* TOTAL *
	* 1984	1985	1986	1987	1988	
5,275	*					* 5,275
115,434	*					* 115,434
1,550	*					* 1,550
600	*					* 600
600	*					* 600
<u>473,862</u>	*					* <u>473,862</u>
597,321	*					* 597,321

110,832	*					* 110,832
<u>486,489</u>	*					* <u>486,489</u>
597,321	*					* 597,321

Countywide

No map required.

Site Change

DEPARTMENT	PRIORITY REQUEST	000	REVISED 10/83
LOCATION -			
CURRENT PROJECT COST ESTIMATE			119,058
EXPENDED & APPROPRIATED (INC RECOMMENDED)			<u>119,058</u>
FUTURE FUNDING REQUIRED TO COMPLETE PROJECT			0
BUDGET *PROGRAM	PROJECTIONS - THOUSANDS OF DOLLARS*		OPT/ACCOUNT
DELETED *			PROGRAM* TOTAL
C)	* 1984	1985 1986 1987 1988	TOTAL *

58	*		* 119,058
58	*		* 119,058

85	*		* 59,985
52	*		* 652
73	*		* 21,273
62	*		* 3,562
86	*		* 33,586
58	*		* 119,058

CAPITAL IMPROVEMENT PROGRAM

No. 1
Eastside

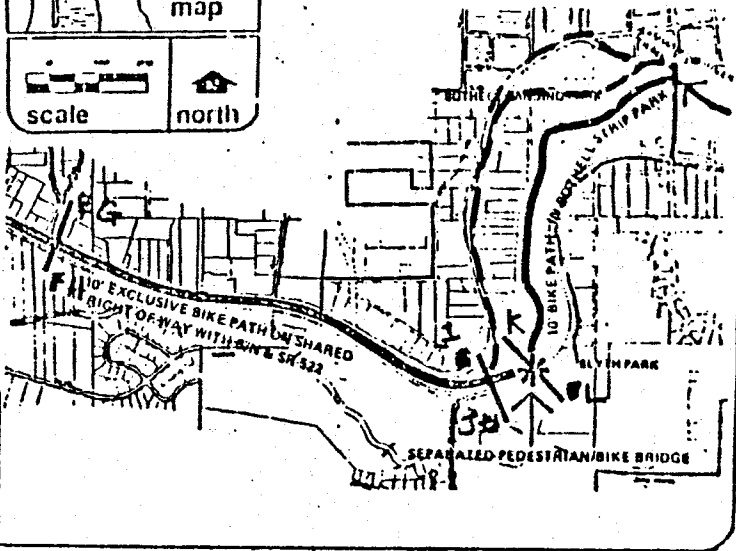
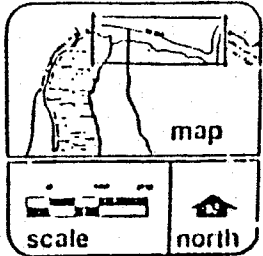

City
ord-
1-
alt paving.
L.I. Site Change

process are
erway.
etion in

CAPITAL IMPROVEMENT PROGRAM

DEPARTMENT PRIORITY REQUEST 000						REVISED 10/83
LOCATION - SAMMAMISH RIVER, REDMOND TO BOTHELL						
CURRENT PROJECT COST ESTIMATE						298,844
EXPENDED & APPROPRIATED (INC RECOMMENDED)						298,844
FUTURE FUNDING REQUIRED TO COMPLETE PROJECT						0
ET	*PROGRAM PROJECTIONS - THOUSANDS OF DOLLARS*					OPT/ACCOUNT
ED	PROGRAM*					TOTAL
* 1984	1985	1986	1987	1988	TOTAL	*

*						*
*						* 47,907
*						* 1,248
*						* 238,394
*						* 5,667
*						* 5,628
*						* 298,844

*						* 121,055
*						* 0
*						* 75,000
*						* 102,789
*						* 298,844

